

EXTERNALLY PRESSURIZED EXPANSION JOINT / 5200



PN 16
DN32 → DN250

PRODUCTION STANDARDS

DESIGN	TS 10880 / DIN30681
END CONNECTION	FLANGED TS EN 1092-1 / ISO 7005-1 WELDING END TS EN 12627
FACE TO FACE	TS 10880 / DIN30681
TEST	TS 10880 / DIN30681
MARKING	TS EN 19 / TS 10880/ DIN30681

FEATURES

- FAF5200 External pressurized expansion joint is preferred in pipelines that expansion arising from temperature differences.
- Twists that may occur is eliminated via pressure balance which is provided by fluid pressure to influence the outer surface of the bellows.
- Due to isolated from external environment the risk of impairment is put away because of external factors.
- It can be manufactured as rotary flanges (FAF5210), Welding Ends (FAF5220)

APPLICATIONS

Steam, Hot Water, Cold Water, Potable Water, Superheated Water, Gas Networks, Chemicals, Pressurized Air

TEMPERATURE

-20, +430 °C

TECHNICAL DRAWING

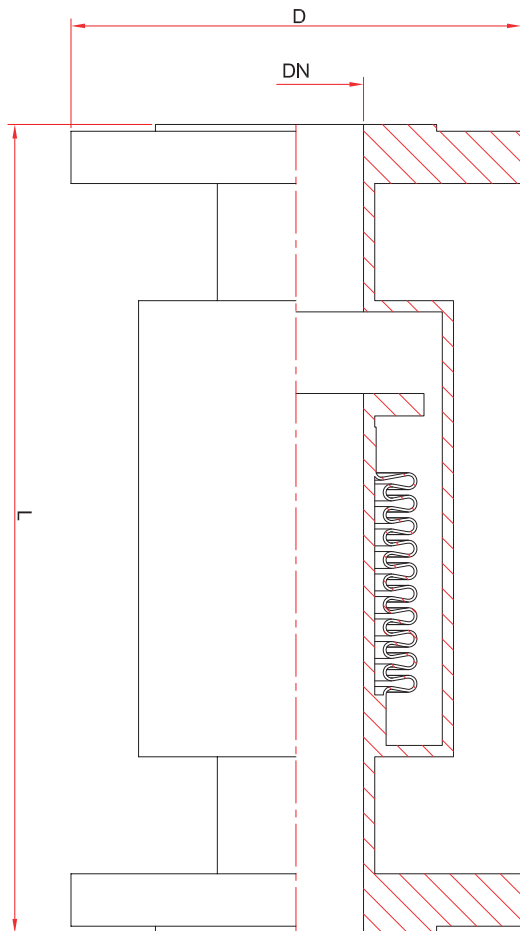

MATERIAL SELECTION

BELLOW
 1.4301 - AISI 304 STAINLESS STEEL
 1.4401 - AISI 316 STAINLESS STEEL
 1.4541 - AISI 321 STAINLESS STEEL

WELDING END
 1.0037 - ST 37 STEEL
 1.4301 - AISI 304 STAINLESS STEEL
 1.4401 - AISI 316 STAINLESS STEEL

INTERIOR PIPE
 1.0037 - ST 37 STEEL
 1.4301 - AISI 304 STAINLESS STEEL
 1.4401 - AISI 316 STAINLESS STEEL

EXTERIOR PIPE
 1.0037 - ST 37 STEEL
 1.4301 - AISI 304 STAINLESS STEEL
 1.4401 - AISI 316 STAINLESS STEEL

FLANGED EXPANSION JOINT				
DN	DIMENSION			RATINGS
mm	D	L +/-5	Expansion Range	Weight kg
32	140	295	-20/+10	5,4
		150	-40/+20	6,6
		165	-60/+30	7,8
40	150	295	-20/+10	6,7
		200	-40/+20	8,2
		220	-60/+30	9,6
50	165	300	-20/+10	9,5
		285	-40/+20	11,6
		340	-60/+30	13,7
65	185	310	-20/+10	11,0
		400	-40/+20	13,5
		515	-60/+30	16,0
80	200	315	-20/+10	14,5
		405	-40/+20	17,5
		525	-60/+30	20,7
100	220	315	-20/+10	18,2
		405	-40/+20	20,7
		525	-60/+30	24,3
125	250	325	-20/+10	24,7
		425	-40/+20	30,0
		535	-60/+30	35,3
150	285	335	-20/+10	28,0
		440	-40/+20	33,5
		550	-60/+30	41,0
200	340	390	-20/+10	50,0
		500	-40/+20	57,5
		610	-60/+30	70,5
250	405	390	-20/+10	61,8
		500	-40/+20	72,0
		610	-60/+30	93,5

* Valves can be produced with bigger sizes when requested.