

BALL VALVE / 1440 THREADED



PN 16-25-40
DN15 → DN25

PRODUCTION STANDARDS

DESIGN	TS EN 331 / TS EN 1983
END CONNECTION	THREADED TS EN ISO 228-1
FACE TO FACE	DIN3202 - M3
TEST	TS EN 12266-1 / TS EN 331
MARKING	TS EN 19

FEATURES

- FAF 1440, screwed end ball valve is operating by a ball having a hole with the same size as the flow section, through the help of the stem, rotating quarter turn (90 degree) between teflon seats where the ball to be parallel or perpendicular to the flow axis
- Can be installed bidirectional
- It's body can be made of steel, forged steel and stainless steel
- Ball and stem are stainless steel, sealings are teflon(PTFE)
- Default production is with female/female connection
- On request, can be manufactured with male/male, male/female and welding end connections
- It has high-pressure resistance. Pressure ratings can be PN 10/16/25/40 or Class 800/1500

APPLICATIONS

Natural Gas, Superheated Water, Steam, Fluids without acidity or alkalinity properties, LPG

TEMPERATURE

+200 °C

TECHNICAL DRAWING

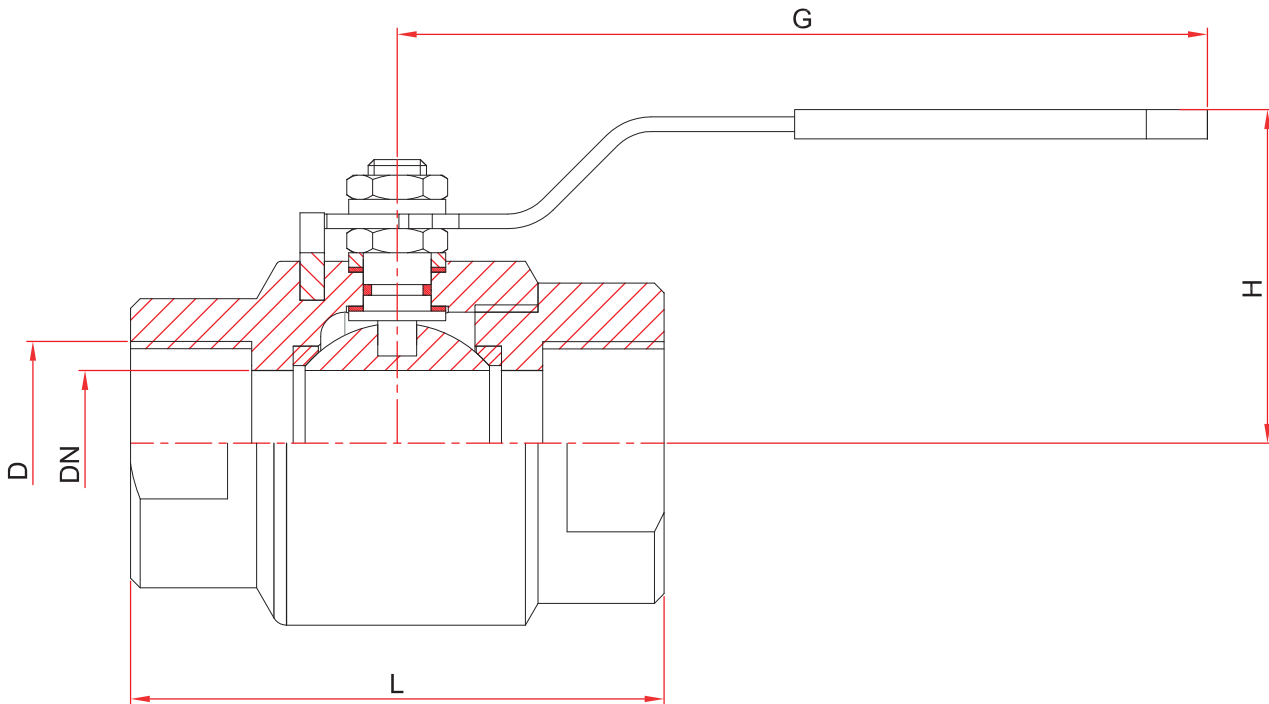

MATERIAL SELECTION

DN	DIMENSION				RATINGS		
	Ømm	D	L	H	G	KV m ³ /h	Tork Nm
15	R 1/2	75	60	140	18	7	0,7
20	R 3/4	80	70	150	35	7	1,4
25	R 1	90	75	150	65	7	1,7

BODY
 1.0037 - ST37 STEEL
 ASTM A-105 FORGED STEEL
 1.4301 - AISI 304 STAINLESS STEEL
 1.4401 - AISI 316 STAINLESS STEEL

BALL
 1.4021 - AISI 420 STAINLESS STEEL
 1.4301 - AISI 304 STAINLESS STEEL
 1.4401 - AISI 316 STAINLESS STEEL

STEM
 1.4021 - AISI 420 STAINLESS STEEL
 1.4301 - AISI 304 STAINLESS STEEL
 1.4401 - AISI 316 STAINLESS STEEL

SEALING TEFLON (PTFE)

COATING INDUSTRIAL EPOXY